

RESIDENCES AT
MORNING VISTA
OV 2102029
GRADING PERMIT
#2501679
SITE RESOURCE
INVENTORY

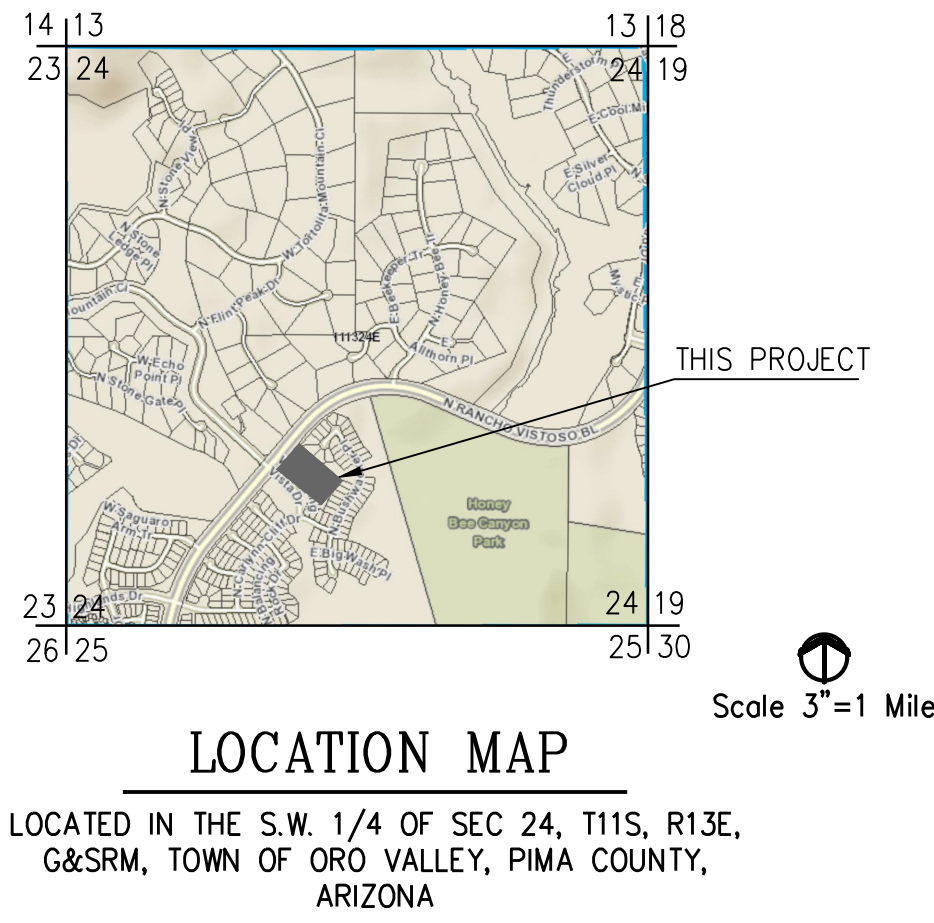

SITE RESOURCE INVENTORY (SRI) NOTES:

1. All salvage plans shall be field checked by Zoning Inspector, prior to approval. If there are any changes to the salvage plan based on the field check, the salvage plan shall be revised.
2. Protected native plants shall not be destroyed, mutilated, removed from the premises or relocated on the premises except in accordance with an approved Native Preservation Plan, Salvage, and Mitigation Plan and all Arizona Department of Agriculture and Horticulture requirements.
3. Mitigation of Significant Vegetation shall be in accordance with 27.6.B.3.b.iii.
4. Site is Zoned PAD (Rancho Vistoso).
5. Adjacent parcels zoned PAD (Rancho Vistoso).
6. The original vegetation inventory for this site was performed by Novak Environmental, Inc. in 2021.
7. See sheet SRI-2 of this set for a full list of SV plants.
8. Significant Vegetation information:
Total amount present on-site (square feet): 13,448.43
Total amount being disturbed (square feet): 10,412.36
Total percentage disturbed: 77%. This calculation is based on the square feet of disturbed significant vegetation. See Sheet SRI-2 for calculations based on number of plants being disturbed.

RANCHO VISTOSO HILLSIDE DISTRICT – SEE CIVIL PLANS
100-YEAR FLOOD LIMITS – NONE ON SITE.
ROCK OUTCROPS– NONE ON SITE.

OWNER/DEVELOPER
DSW Commercial Real Estate
Attn: Michael A. Sorabia
1795 E. Skyline Dr., STE 193
Tucson, AZ 85718
Phone: 520-297-8929
Email: msorabia@dswwcommercial.com

CIVIL ENGINEER
GRENIER ENGINEERING, INC.
Attn: John Grenier, P.E.
6300 E. El Dorado Plaza, Suite A120, Tucson, AZ 85715
Phone: 520-326-7082
Email: jgrenier@greniereng.com

ARCHITECT
McMAHON DESIGN BUILD, LLC
Attn: Jim McMahon
6340 North Campbell Avenue
Tucson, AZ 85718
Phone: 520-321-0468
Email: jimcmahon@aol.com

LANDSCAPE ARCHITECT
Novak Environmental, Inc.
Attn: Karen Cesare, RLA
4574 N First Avenue, Suite 100
Tucson, AZ 85718
Phone: 520-206-0591
Email: karen@novakenvironmental.com

Novak Environmental, Inc.
4574 North First Avenue • #100 Tucson, AZ 85718
Phone 520.206.0591 Fax 520.882.3006
Landscape Architecture • Natural Resources • Planning • Mitigation

Reference Case 2003075 Pre-Application

Rev #		Date	Description
1		4/19/22	SITE RESOURCE INVENTORY
2		4/19/22	RESIDENCES AT MORNING VISTA
3		4/19/22	SRI-1
4		4/19/22	SRI-2
5		4/19/22	SRI-3
6		4/19/22	SRI-4
7		4/19/22	SRI-5
8		4/19/22	SRI-6
9		4/19/22	SRI-7
10		4/19/22	SRI-8
11		4/19/22	SRI-9
12		4/19/22	SRI-10
13		4/19/22	SRI-11
14		4/19/22	SRI-12
15		4/19/22	SRI-13
16		4/19/22	SRI-14
17		4/19/22	SRI-15
18		4/19/22	SRI-16
19		4/19/22	SRI-17
20		4/19/22	SRI-18
21		4/19/22	SRI-19
22		4/19/22	SRI-20
23		4/19/22	SRI-21
24		4/19/22	SRI-22
25		4/19/22	SRI-23
26		4/19/22	SRI-24
27		4/19/22	SRI-25
28		4/19/22	SRI-26
29		4/19/22	SRI-27
30		4/19/22	SRI-28
31		4/19/22	SRI-29
32		4/19/22	SRI-30
33		4/19/22	SRI-31
34		4/19/22	SRI-32
35		4/19/22	SRI-33
36		4/19/22	SRI-34
37		4/19/22	SRI-35
38		4/19/22	SRI-36
39		4/19/22	SRI-37
40		4/19/22	SRI-38
41		4/19/22	SRI-39
42		4/19/22	SRI-40
43		4/19/22	SRI-41
44		4/19/22	SRI-42
45		4/19/22	SRI-43
46		4/19/22	SRI-44
47		4/19/22	SRI-45
48		4/19/22	SRI-46
49		4/19/22	SRI-47
50		4/19/22	SRI-48
51		4/19/22	SRI-49
52		4/19/22	SRI-50
53		4/19/22	SRI-51
54		4/19/22	SRI-52
55		4/19/22	SRI-53
56		4/19/22	SRI-54
57		4/19/22	SRI-55
58		4/19/22	SRI-56
59		4/19/22	SRI-57
60		4/19/22	SRI-58
61		4/19/22	SRI-59
62		4/19/22	SRI-60
63		4/19/22	SRI-61
64		4/19/22	SRI-62
65		4/19/22	SRI-63
66		4/19/22	SRI-64
67		4/19/22	SRI-65
68		4/19/22	SRI-66
69		4/19/22	SRI-67
70		4/19/22	SRI-68
71		4/19/22	SRI-69
72		4/19/22	SRI-70
73		4/19/22	SRI-71
74		4/19/22	SRI-72
75		4/19/22	SRI-73
76		4/19/22	SRI-74
77		4/19/22	SRI-75
78		4/19/22	SRI-76
79		4/19/22	SRI-77
80		4/19/22	SRI-78
81		4/19/22	SRI-79
82		4/19/22	SRI-80
83		4/19/22	SRI-81
84		4/19/22	SRI-82
85		4/19/22	SRI-83
86		4/19/22	SRI-84
87		4/19/22	SRI-85
88		4/19/22	SRI-86
89		4/19/22	SRI-87
90		4/19/22	SRI-88
91		4/19/22	SRI-89
92		4/19/22	SRI-90
93		4/19/22	SRI-91
94		4/19/22	SRI-92
95		4/19/22	SRI-93
96		4/19/22	SRI-94
97		4/19/22	SRI-95
98		4/19/22	SRI-96
99		4/19/22	SRI-97
100		4/19/22	SRI-98
101		4/19/22	SRI-99
102		4/19/22	SRI-100
103		4/19/22	SRI-101
104		4/19/22	SRI-102
105		4/19/22	SRI-103
106		4/19/22	SRI-104
107		4/19/22	SRI-105
108		4/19/22	SRI-106
109		4/19/22	SRI-107
110		4/19/22	SRI-108
111		4/19/22	SRI-109
112		4/19/22	SRI-110
113		4/19/22	SRI-111
114		4/19/22	SRI-112
115		4/19/22	SRI-113
116		4/19/22	SRI-114
117		4/19/22	SRI-115
118		4/19/22	SRI-116
119		4/19/22	SRI-117
120		4/19/22	SRI-118
121		4/19/22	SRI-119
122		4/19/22	SRI-120
123		4/19/22	SRI-121
124		4/19/22	SRI-122
125		4/19/22	SRI-123
126		4/19/22	SRI-124
127		4/19/22	SRI-125
128		4/19/22	SRI-126
129		4/19/22	SRI-127
130		4/19/22	SRI-128
131		4/19/22	SRI-129
132		4/19/22	SRI-130
133		4/19/22	SRI-131
134		4/19/22	SRI-132
135		4/19/22	SRI-133
136		4/19/22	SRI-134
137		4/19/22	SRI-135
138		4/19/22	SRI-136
139		4/19/22	SRI-137
140		4/19/22	SRI-138
141		4/19/22	SRI-139
142		4/19/22	SRI-140
143		4/19/22	SRI-141
144		4/19/22	SRI-142
145		4/19/22	SRI-143
146		4/19/22	SRI-144
147		4/19/22	SRI-145
148		4/19/22	SRI-146
149		4/19/22	SRI-147
150		4/19/22	SRI-148
151		4/19/22	SRI-149
152		4/19/22	SRI-150
153		4/19/22	SRI-151
154		4/19/22	SRI-152
155		4/19/22	SRI-153
156		4/19/22	SRI-154
157		4/19/22	SRI-155
158		4/19/22	SRI-156
159		4/19/22	SRI-157
160		4/19/22	SRI-158
161		4/19/22	SRI-159
162		4/19/22	SRI-160
163		4/19/22	SRI-161
164		4/19/22	SRI-162
165		4/19/22	SRI-163
166		4/19/22	SRI-164
167		4/19/22	SRI-165
168		4/19/22	SRI-166
169		4/19/22	SRI-167
170		4/19/22	SRI-168
171		4/19/22	SRI-169
172		4/19/22	SRI-170
173		4/19/22	SRI-171
174		4/19/22	SRI-172
175		4/19/22	SRI-173
176		4/19/22	SRI-174
177		4/19/22	SRI-175
178		4/19/22	SRI-176
179		4/19/22	SRI-177
180		4/19/22	SRI-178
181		4/19/22	SRI-179
182		4/19/22	SRI-180
183		4/19/22	SRI-181
184		4/19/22	SRI-182
185		4/19/22	SRI-183
186		4/19/22	SRI-184
187		4/19/22	SRI-185
188		4/19/22	SRI-186
189		4/19/22	SRI-187
190		4/19/22	SRI-188
191		4/19/22	SRI-189
192		4/19/22	SRI-190
193		4/19/22	SRI-191
194		4/19/22	SRI-192
195		4/19/22	SRI-193
196		4/19/22	SRI-194
197		4/19/22	SRI-195
198		4/19/22	SRI-196
199		4/19/22	SRI-197
200		4/19/22	SRI-198
201		4/19/22	SRI-199
202		4/19/22	SRI-200
203		4/19/22	SRI-201
204		4/19/22	SRI-202
205		4/19/22	SRI-203
206		4/19/22	SRI-204
207		4/19/22	SRI-205
208		4/19/22	SRI-206
209		4/19/22	SRI-207
210		4/19/22	SRI-208
211		4/19/22	SRI-209
212		4/19/22	SRI-210
213		4/19/22	SRI-211
214		4/19/22	SRI-212
215		4/19/22	SRI-213
216		4/19/22	SRI-214
217		4/19/22	SRI-215
218		4/19/22	SRI-216
219		4/19/22	SRI-217
220		4/19/22	SRI-218
221		4/19/22	SRI-219
222		4/19/22	SRI-220
223		4/19/22	SRI-221
224		4/19/22	SRI-222
225		4/19/22	SRI-223
226		4/19/22	SRI-224
227		4/19/22	SRI-225
228		4/19/22	SRI-226
229		4/19/22	SRI-227
230		4/19/22	SRI-228
231		4/19/22	SRI-229
232		4/19/22	SRI-230
233		4/19/22	SRI-231
234		4/19/22	SRI-232
235		4/19/22	SRI-233
236		4/19/22	SRI-234
237		4/19/22	SRI-235
238		4/19/22	SRI-236
239		4/19/22	SRI-237
240		4/19/22	SRI-238
241		4/19/22	SRI-239
242		4/19/22	SRI-240
243		4/19/22	SRI-241
244		4/19/22	SRI-242
245		4/19/22	SRI-243
246		4/19/22	SRI-244
247		4/19/22	SRI-245
248		4/19/22	SRI-246
249		4/19/22	SRI-247
250		4/19/22	SRI-248
251		4/19/22	SRI-249
252		4/19/22	SRI-250
253		4/19/22	SRI-251
254		4/19/22	SRI-252
255		4/19/22	SRI-253
256		4/19/22	SRI-254
257		4/19/22	SRI-255
258		4/19/22	SRI-256
259		4/19/22	SRI-257
260		4/19/22	SRI-258
261		4/19/22	SRI-259
262		4/19/22	SRI-260
263		4/19/22	SRI-261
264		4/19/22	SRI-262
265		4/19/22	SRI-263
266		4/19/22	SRI-264
267		4/19/22	SRI-265
268		4/19/22	SRI-266
269		4/19/22	SRI-267
270		4/19/22	SRI-268
271		4/19/22	SRI-269
272		4/19/22	SRI-270
273		4/19/22	SRI-271
274		4/19/22	SRI-272
275		4/19/22	SRI-273
276		4/19/22	SRI-274
277		4/19/22	SRI-275
278		4/19/22	SRI-276
279		4/19/22	SRI-277
280		4/19/22	SRI-278
281		4/19/22	SRI-279
282		4/19/22	SRI-280
283		4/19/22	SRI-281
284		4/19/22	SRI-282
285		4/19/22	SRI-283
286		4/19/22	SRI-284
287		4/19/22	SRI-285
288		4/19/22	SRI-286
289		4/19/22	SRI-287
290		4/19/22	SRI-288
291		4/19/22	SRI-289
292		4/19/22	SRI-290
293		4/19/22	SRI-291
294		4/19/22	SRI-292
295		4/19/22	SRI-293
296</			

PROTECTED NATIVE PLANTS (PNP) SIGNIFICANT VEGETATION

I.D.#	Botanical Name	Caliper Inches	Multi Trunk	Height Feet	In-situ Viability	Notes	Transplant Rating	Unsalvagable Criteria	PIP	TOS	MIT	RFS
1	Parkinsonia florida	24	Y	12	L	deadwood	L	A, C				
15	Parkinsonia florida	36	Y	14	M	deadwood	L	A, C			MIT	
37	Parkinsonia florida	22	Y	13	L		L	A, C, G				RFS
41	Parkinsonia florida	48	Y	25	M		L	A, B, C, G				RFS
42	Parkinsonia florida	36	Y	25	M		L	A, C, G			MIT	
43	Parkinsonia florida	36	Y	18	M		L	A, C, G			MIT	
44	Parkinsonia florida	36	Y	17	M	deadwood	L	A, C, G			MIT	
52	Parkinsonia florida	24	Y	16	L	deadwood	L	A, C, G			MIT	
58	Parkinsonia microphylla	32	Y	18	L	deadwood	L	A, C, G				RFS
61	Parkinsonia microphylla	16	Y	13	M		L	A, C, G				RFS
73	Parkinsonia microphylla	18	Y	14	H		H	A, C		TOS		
101	Parkinsonia florida	30	Y	15	L	deadwood	L	A, C				RFS
115	Parkinsonia florida	24	Y	15	L	damaged and bores	L	A, C, G				RFS
148	Prosopis velutina	24	Y	12	L	deadwood	L	A, C, G				RFS
174	Parkinsonia microphylla	14	Y	15	L	deadwood	L	A, C, G				RFS
198	Parkinsonia microphylla	14	Y	12	L	deadwood	L	A				RFS
202	Parkinsonia microphylla	14	Y	12	M	deadwood	L	A, C, G				RFS
204	Parkinsonia microphylla	14	Y	12	L	deadwood	L	A				RFS
205	Parkinsonia microphylla	14	N	14	L	deadwood	L	A, C, G				RFS
210	Parkinsonia microphylla	14	Y	13	L	deadwood	L	A, C, G				RFS
212	Prosopis velutina	16	N	18	L	deadwood	L	A, C, G				RFS
215	Parkinsonia microphylla	14	Y	12	L	deadwood	L	A, C, G				RFS
220	Parkinsonia microphylla	14	Y	12	L	deadwood	L	A, C, G				RFS
223	Parkinsonia microphylla	30	Y	14	L	deadwood	L	A, C, G				RFS
1000	Parkinsonia florida	8	Y	15	M		M				MIT	
1001	Parkinsonia florida	6	N	12	M		M				MIT	
1007	Parkinsonia florida	18	Y	12	H		H			TOS		
1015	Parkinsonia florida	14	Y	18	L		L	A, C, G				RFS
1021	Parkinsonia florida	14	N	18	M		L		PIP			
1022	Parkinsonia florida	14	N	14	M		H		PIP			
1024	Parkinsonia florida	20	Y	25	L		L		PIP			
1028	Parkinsonia florida	0	N	12	L		L		PIP			
1046	Parkinsonia florida	12	N	15	M		L		PIP			
1047	Parkinsonia florida	12	Y	20	M		L		PIP			
1048	Parkinsonia florida	12	Y	14	M		L		PIP			
1052	Parkinsonia florida	14	N	14	M		L		PIP			
1063	Parkinsonia florida	18	Y	20	L		L	A, C, G				RFS
1065	Parkinsonia florida	18	Y	30	L		L	A, C, G				RFS
1086	Parkinsonia florida	18	Y	20	L		L	A, C, G				RFS
1093	Parkinsonia florida	20	Y	25	L		L	A, C, G				RFS
1097	Parkinsonia florida	14	Y	18	L		L	A, C, G				RFS

NATIVE PLANT SUMMARY TABLE

Botanical Name	Common Name	Transplant	Remove from site	Preserve in Place	Total per Plant
Carnegiea gigantea	Saguaro	10	0	0	10
Ferocactus wislizeni	Fishhook Barrel Cactus	29	12	8	49
Fouquieria splendens	Ocotillo	13	1	0	14
Mammillaria thornberi	Thornber's Fishhook Cactus	24	1	0	25
Parkinsonia florida	Blue Palo Verde	5	40	21	66
Parkinsonia microphyllum	Foothills Palo Verde	2	33	2	37
Prosopis velutina	Velvet Mesquite	2	5	1	8
Opuntia fulgida var. fulgida	Chain Fruit Cholla	0	5	0	5
Opuntia phaeacantha var. discata	Engelmann Prickly Pear	0	10	1	11
Vachellia constricta	White-thorn Acacia	0	5	0	5
TOTAL		85	112	33	230

TRANSPLANT ON SITE SUMMARY

Plant Species	#
Carnegiea gigantea	10
Ferocactus wislizeni	29
Fouquieria splendens	13
Mammillaria thornberi	24
Parkinsonia florida	5
Parkinsonia microphylla	2
Prosopis velutina	2
TOTAL	85

MITIGATION SUMMARY

Plant Species	#	Understory Required (5 per tree)
Ferocactus wislizeni	2	0
Opuntia fulgida var. fulgida	18	0
Opuntia phaeacantha var. discata	35	0
Parkinsonia florida	13	65
Parkinsonia microphylla	13	65
Prosopis velutina	2	10
Senegalia greggii	1	5
TOTAL	84	145

Code	Determination of Transplantability
A	Plant health is good to excellent with no major infestations or apparent diseases. "Plant health" is defined as a plant in a sound state, free from disease and expected to survive for five or more years.
B	The plant is of a size and age to suggest a likely chance of transplant survival.
C	Plant is undamaged and is conducive to box or spade transplanting (upright branching)
D	Soils can be excavated, are cohesive, and appear capable of supporting a boxed or spaded root ball.
E	Surrounding topography permits access with the appropriate equipment needed to box or spade and remove the plant.
F	Adjacent plants do not pose a likely interference with root systems or interfere with plant removal.
G	The overall form and character is representative of the species and is a valuable specimen for landscape or habitat purposes.

NOTE: Determination of Transplantability is from Oro Valley Zoning Code 27.6.A.4.c.iii. Applicable letters are assigned to plants when they do not meet that standard, and are therefor deemed unsalvagable.

SIGNIFICANT VEGETATION MITIGATION SUMMARY

Mitigation of Significant Vegetation		
Significant Plants On-Site	41	100.0%
Significant Plants to be Disturbed	33	80.5%
Significant Plants Disturbed Meeting Salvage Criteria (See Note #3)	7	
Additional Mitigation Required	14	

Transplant On Site	
Plant	#
Parkinsonia microphylla	1
Parkinsonia florida	1

SIGNIFICANT VEGETATION MITIGATION TABLES

Number Removed	Name	Mitigation Ratio	Replacement Plants	Understory Ratio	Understory Required
7	Parkinsonia florida	2:1	14	5:1	35
Mitigation Plants					
	36" Box	48" Box	Understory Ratio (per mitigated tree)	Understory Plants	
Parkinsonia florida	7	7	5:1	35	

NOTES:

- The Plant Identification Numbers have some breaks in sequence to account for plants removed from the set because they were found to be located off of the property and not applicable to this project or did not meet the criteria for "Significant Vegetation". Plants found to be off property were not counted and or used in any form for calculations related to this project.
- Any Significant Vegetation (SV) plants (PNP) are denoted with "•".
- Mitigation of Significant Vegetation shall be in accordance with 27.6.B.3.b.iii.



Novak Environmental, Inc.
4574 North First Avenue •#100 Tucson, AZ 85718
Phone 520.206.0591 Fax 520.882.3006
Landscape Architecture • Natural Resources • Planning • Mitigation

Reference Case 2003075 Pre-Application

Rev #	Date	Description	
			
6300 E. El Dorado Plaza Suite A120, Tucson, Arizona 85715 Phone: 520.326.7082 ~ Fax: 520.326.7508		Job Number: NE 21024 Designed By: SS Drawn By: SS Checked By: KC Date: APRIL 2022 Scale: Vt: N/A Hz:	
Sheet Name SITE RESOURCE INVENTORY		Project RESIDENCES AT MORNING VISTA	
SRI-2		Sheet 2 of 2	

NOTICE OF DRAWING AUTHORIZATION: THIS DRAWING IS A COPYRIGHT PROTECTED DOCUMENT PRODUCED BY COMPUTER AIDED DESIGN AND DRAFTING TECHNIQUES. MULTIPLE AND/OR UNAUTHORIZED COPIES OF DRAWING DATA FILES MAY EXIST. ANY USE, REUSE OR MODIFICATION OF THE DRAWING OR ITS DATA FILES WITHOUT THE APPROPRIATE AUTHORIZED SIGNED REGISTERED LANDSCAPE ARCHITECTS AND WRITTEN VERIFICATION BY NOVAK ENVIRONMENTAL IS PROHIBITED AND WILL BE AT THE USER'S RISK AND FULL LEGAL RESPONSIBILITY.

Approval Block:

Planning & Zoning Administrator Date



CALL TWO WORKING DAYS BEFORE YOU DIG
602-263-1100
1-800-STAKE-IT
(OUTSIDE MARICOPA COUNTY)

GRADING PERMIT #2501679