

North

SCALE: 1"=150'  
C.I. = 1.0'

# NATIVE PLANT PRESERVATION PLAN

## FOR

### NARANJA TRAILS

#### OV2000939

TOWN OF ORO VALLEY, PIMA COUNTY, ARIZONA  
SUBJECT TO RIVERS EDGE PAD CR-2 ZONING,  
PIMA COUNTY HILLSIDE DEVELOPMENT OVERLAY  
ZONE, AND PIMA COUNTY GRADING REQUIREMENTS.

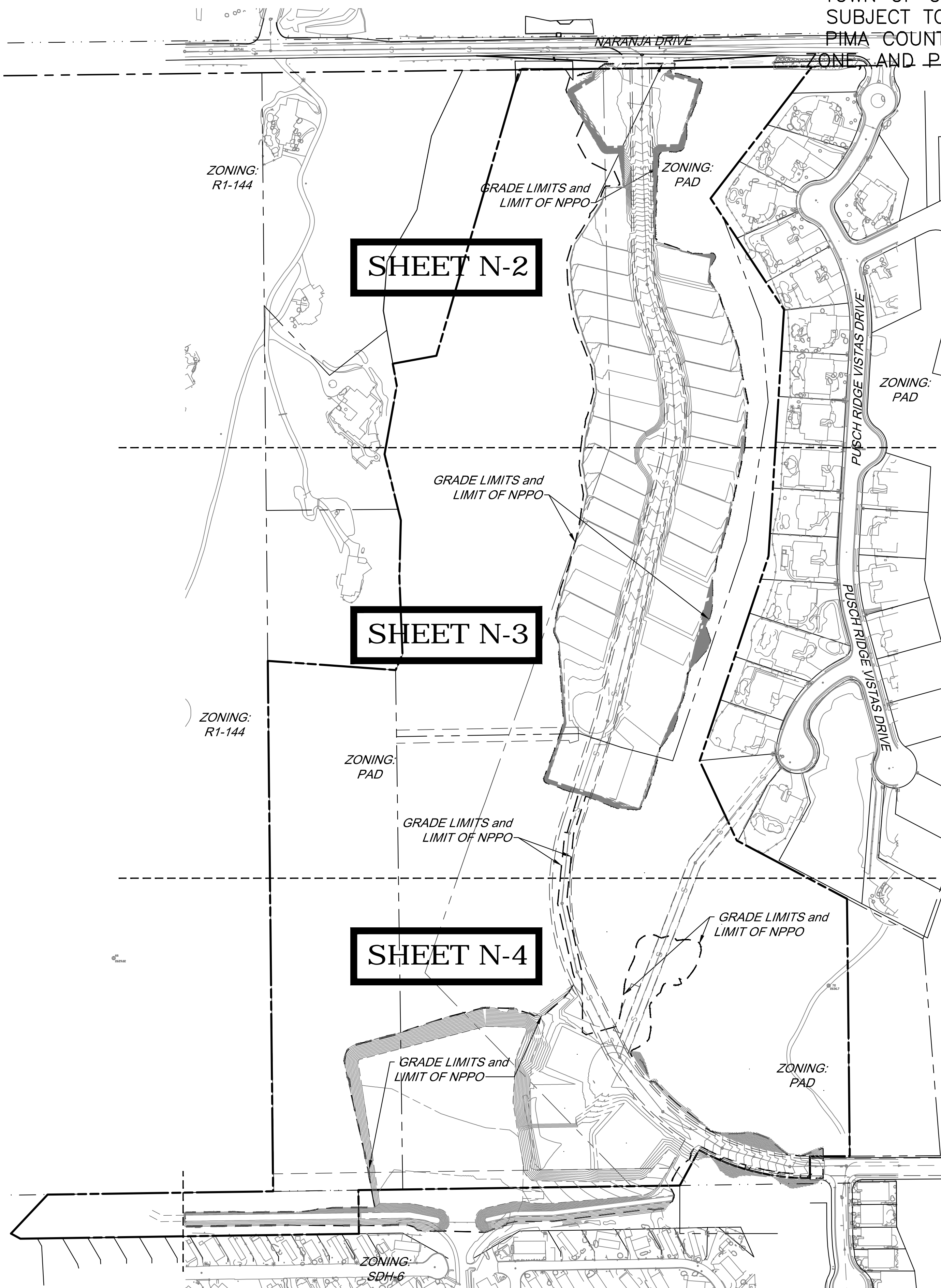

#### NATIVE PLANT PRESERVATION NOTES

- All areas designated to be preserved as natural open space shall be fenced for protection during construction using minimum 4-foot high orange mesh barricade fencing. Protective fencing must remain in place throughout the construction and development process.
- All preserved in place, transplanted and supplemental plants will be fenced at the drip line during construction. The drip line for saguaros will be at a radius of 1/4 the height of the plant. Protective fencing must remain in place throughout the construction and development process.
- The assigned monitor must provide a report to the Subdivision Review Section of the Planning Division that the fencing has been properly installed and that all plant tags are in place before grading permits can be issued.
- The north side of all saguaro and barrel cacti approved for transplanting shall be marked prior to removal to ensure proper orientation in the new location.
- The Owner must hire a monitor for the project. Greg Shinn, GRS Landscape Architects, LLC, 520-877-8037 can provide this monitoring but has not been hired to provide this monitoring.
- Transplanted plant material shall be irrigated by a drip system while in the temporary holding nursery. This system shall be operated by a temporary battery-operated irrigation controller. Maintenance of salvaged plants in the temporary holding nursery shall be performed weekly by the contractor. Maintenance shall include inspection and repair of the irrigation system, adjustment of the irrigation system, pruning, examination and treatment for diseases and pests, and any other work required by the plant monitor.
- Mistletoe infections will be removed from specimens before transplanting.
- Any additional barrel cactus encountered within the limits of construction shall be transplanted within the property. Notify the project monitor of any other additional protected plants encountered during construction.

#### GENERAL NOTES

- Zoning = PAD
- Gross Site Area = 2,527,152 sf (58.02 acres)
- Land Use = Residential
- This site is subject to the River's Edge PAD and not the requirements of Oro Valley. The PAD references the NPPO requirements of Pima County. The PAD further states that the required plant salvage is 1 tree per lot plus some trees within the common area. This PAD requirement supercedes Oro Valley requirements.
- In accordance with the River's Edge PAD, bufferyards have been provided to Pima County Standards and not Oro Valley Standards.
- Any changes in grading limits or development layout must be submitted to the Planning Department to determine if a revised plan will be required.
- Area Calculations:
  - Gross site area = 2,527,152 sf (58.02 acres)
  - Total area graded = 881,367 sf (22.23 acres)
  - Total Natural Open Space (NOS) = 35.79 acres
- Bufferyard elements within sight visibility triangles shall be placed so as not to interfere with a visibility plane described by two horizontal lines located 30 inches and 72 inches above finished grade of the roadway surface.
- One (1) tree transplanted from on site is required on each lot per the PAD requirement (referred to as street tree). Location of the street tree may vary based on driveway location. Each tree will be irrigated from water service at the house.
- Street trees to be planted prior to close of escrow by Home Buyer.

#### ABBREVIATIONS

The following abbreviations were used in the plant tables:

|        |                                                                                                                                                                                          |
|--------|------------------------------------------------------------------------------------------------------------------------------------------------------------------------------------------|
| BL -   | Broken Limbs; Tree has significant broken branches.                                                                                                                                      |
| BT -   | Broken Top, generally used in description of cactus.                                                                                                                                     |
| DW -   | Dead Wood; Tree has significant die back or dead/broken limbs.                                                                                                                           |
| DY -   | Dying; Tree is dying.                                                                                                                                                                    |
| FD -   | Frost Damage.                                                                                                                                                                            |
| LB -   | Low Branched; Tree has many low branches that will need to be removed for salvaged and removal will destroy structure of tree.                                                           |
| LE -   | Leaning; Tree is leaning to the point where salvage will be difficult.                                                                                                                   |
| MS -   | Marginal Salvage; Used during field inventory to identify less desirable salvage candidates to be used if needed to meet % requirements.                                                 |
| MT -   | Tree has significant mistletoe infestation.                                                                                                                                              |
| NS -   | Not Salvageable; These are trees which are not included in the calculations for the site because they are not in salvageable condition, per Section 27.6.4.c.iii of the Oro Valley Code. |
| OT -   | Tree has an old trunk indicating dieback at some point in the past.                                                                                                                      |
| PD -   | Pruning Damage.                                                                                                                                                                          |
| PIP -  | Plants to be preserved in place.                                                                                                                                                         |
| PROX - | Other vegetation in the vicinity will make salvage difficult.                                                                                                                            |
| PS -   | Possible Salvage; Used in the field to identify best potential salvage candidates.                                                                                                       |
| RD -   | Rodent Damage; Rodents have excavated at the base of the tree.                                                                                                                           |
| RFS -  | Plants to be removed from site, damaged or destroyed.                                                                                                                                    |
| RT -   | Rotted Trunk; Trunk has been broken off or rotted out and has hollow areas, making long term health and viability of the tree questionable.                                              |
| SAL -  | Salvage; Used during field inventory to identify trees that should be salvaged regardless of % requirements.                                                                             |
| SL -   | Slope; Tree is on steep slope where salvage will not be possible.                                                                                                                        |
| SO -   | Soils; Soil is rocky or otherwise unsuitable for excavation.                                                                                                                             |
| SR -   | Surface roots are evident, making excavation difficult.                                                                                                                                  |
| ST -   | Stunted.                                                                                                                                                                                 |
| SZ -   | Size of the tree; either spread, caliper or height is not conducive to salvage.                                                                                                          |
| TD -   | Trunk Damage.                                                                                                                                                                            |
| TM -   | Too Multi; Tree has multiple trunks coming out of the ground that will make moving the tree difficult without significant damage.                                                        |
| TOS -  | Plant to be transplanted on site.                                                                                                                                                        |

#### OWNER

PREMIER BUILDING GROUP  
3191 E. 44th STREET  
TUCSON, ARIZONA 85713  
CONTACT: ROD DAVIS  
PHONE: 520-293-0300

#### DEVELOPER

MERITAGE HOMES  
5326 N. LA CHOLLA BLVD.  
TUCSON, ARIZONA 85741  
CONTACT: LISA HOSKIN  
PHONE: 520-225-6853

#### CIVIL ENGINEER

ATWELL  
250 N. MEYER AVE.  
TUCSON, ARIZONA 85701  
PHONE: 520-784-3816  
CONTACT: DENNIS ROBERTS  
DENNISROBERTS@ATWELL-GROUP.COM  
REGISTRATION #53027

Approval:  
Town of Oro Valley

Planning & Zoning Administrator

Date

SCALE: 1" = 150'-0"  
CONTOUR INTERVAL = 12"

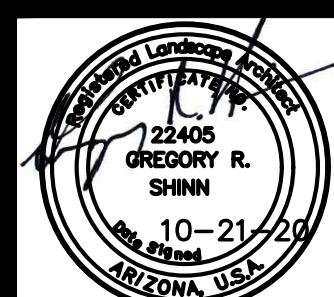

35974 S. Desert Sun Drive  
Tucson, AZ 85739  
(520) 909-4678  
gregs@grslandscapearchitects.com

Date: 10/21/20  
Drawn by: LMW  
Checked by: GRS  
☐ Design Review  
☐ Construction Documents  
☐ Agency Submittal  
☐ Construction Set  
☒ Not for Construction

N-1

1 of 5

#### INDEX OF SHEETS

COVER SHEET 1 OF 5  
NPPO AERIALS 2-4 OF 5  
INVENTORY LIST 5 OF 5

PROJECT NUMBER:  
OV2000939

PIMA COUNTY CASE NO.  
C09-85-72

#### NATIVE PLANT PRESERVATION PLAN

##### NARANJA TRAILS

LOTS 1-46 & COMMON AREAS A THROUGH C, TOWN OF ORO VALLEY,  
PIMA COUNTY, ARIZONA  
A Portion of the East Half of the Northwest Quarter of Section 12, T-12-S,  
R-13-E, G&SRM, Town of Oro Valley, Pima County, AZ



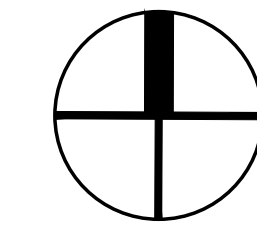

North  
SCALE: 1" = 50'  
C.I. = 1.0'



MATCHLINE -- SEE SHEET N-3

SCALE: 1" = 50-0"  
CONTOUR INTERVAL = 12"

PROJECT NUMBER:  
OV2000939  
PIMA COUNTY CASE NO.  
C09-85-72

**NATIVE PLANT PRESERVATION PLAN**  
**NARANJA TRAILS**  
LOTS 1-46 & COMMON AREAS A THROUGH C, TOWN OF ORO VALLEY,  
PIMA COUNTY, ARIZONA  
A Portion of the East Half of the Northwest Quarter of Section 12, T-12-S,  
R-13-E, G&SRM, Town of Oro Valley, Pima County, AZ

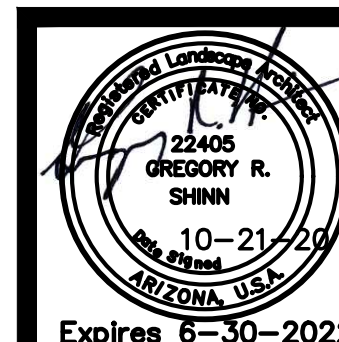

35974 S. Desert Sun Drive  
Tucson, AZ 85739  
(520) 909-4678  
gregs@grslandscapearchitects.com

Date: 10/21/20  
Drawn by: LMW  
Checked by: GRS  
☐ Design Review  
☐ Construction Documents  
☐ Agency Submittal  
☐ Construction Set  
☒ Not for Construction

N-2

2 of 5





North  
SCALE: 1"= 50'  
C.I. = 1.0'

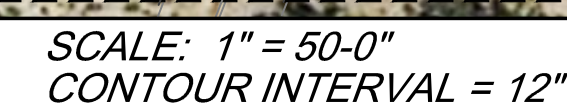

22405  
GREGORY R.  
SHINN  
10-21-20  
ARIZONA, U.S.A.  
Expires 6-30-2022



35974 S. Desert Sun Drive  
Tucson, AZ 85739  
(520) 909-4678  
gregs@grslandscapearchitects.com

Date: 10/21/20

Drawn by: LMW

Checked by: GRS

☐ Design Review

☐ Construction Documents

☐ Agency Submittal

☐ Construction Set

☒ Not for Construction

3 of 5





North  
SCALE: 1"= 50'  
C.I. = 1.0'



**MATCHLINE --  
THIS SHEET, ABOVE**

Expires 6-30-2022



Date: 10/21/20

Drawn by: LMW

Checked by: GRS

☐ Design Review

☐ Construction Documents

☐ Agency Submittal

☐ Construction Set

☒ Not for Construction

**N-4**

4 of 5



| PLANT INVENTORY |                                       |      |   | VIABILITY  |     | RECOMMEND |  |  |  |
|-----------------|---------------------------------------|------|---|------------|-----|-----------|--|--|--|
| ID NO.          | DESCRIPTION                           | SIZE |   | TRANSPLANT |     | COMMENTS  |  |  |  |
| 100             | Prosopis velutina - Native Mesquite   | 12   | M | M          | RFS | SL        |  |  |  |
| 119             | Cercidium floridum - Blue Palo Verde  | 4    | H | H          | TOS | PS,SO     |  |  |  |
| 122             | Cercidium microphyllum - Palo Verde   | 8    | H | L          | RFS | SL        |  |  |  |
| 123             | Cercidium microphyllum - Palo Verde   | 12   | L | L          | NV  | SL,DW     |  |  |  |
| 124             | Cercidium microphyllum - Palo Verde   | 12+  | L | L          | NV  | SL,DW     |  |  |  |
| 125             | Cercidium microphyllum - Palo Verde   | 18+  | L | L          | NV  | SL,DW     |  |  |  |
| 132             | Cercidium microphyllum - Palo Verde   | 6    | M | M          | RFS | ,SO       |  |  |  |
| 133             | Cercidium microphyllum - Palo Verde   | 8    | M | L          | RFS | SL,SO     |  |  |  |
| 134             | Cercidium microphyllum - Palo Verde   | 8    | M | L          | RFS | SL,SO     |  |  |  |
| 135             | Cercidium microphyllum - Palo Verde   | 12   | M | L          | RFS | SL,SO,SZ  |  |  |  |
| 136             | Cercidium microphyllum - Palo Verde   | 10   | M | L          | RFS | SL,SZ     |  |  |  |
| 138             | Cercidium microphyllum - Palo Verde   | 10   | M | L          | RFS | LB,SL     |  |  |  |
| 144             | Cercidium microphyllum - Palo Verde   | 10   | M | L          | RFS | LB,DW     |  |  |  |
| 145             | Cercidium microphyllum - Palo Verde   | 18+  | L | L          | NV  | RT        |  |  |  |
| 146             | Cercidium microphyllum - Palo Verde   | 12+  | L | L          | NV  | LB        |  |  |  |
| 150             | Cercidium microphyllum - Palo Verde   | 18+  | M | L          | RFS | SL,SZ     |  |  |  |
| 151             | Cercidium microphyllum - Palo Verde   | 10   | M | L          | RFS | SL        |  |  |  |
| 152             | Prosopis velutina - Native Mesquite   | 18+  | L | L          | NV  | DW,BL     |  |  |  |
| 153             | Cercidium microphyllum - Palo Verde   | 6    | L | L          | NV  | DY        |  |  |  |
| 154             | Celtis pallida - Hackberry            | 8    | M | M          | RFS | VMS       |  |  |  |
| 155             | Prosopis velutina - Native Mesquite   | 12   | M | L          | RFS | SZ,DW     |  |  |  |
| 156             | Acacia greggii - Catclaw Acacia       | 12+  | M | L          | RFS | LE,DW     |  |  |  |
| 158             | Acacia constricta - Whitethorn Acacia | 6    | M | M          | TOS | VMS,LB    |  |  |  |
| 160             | Cercidium floridum - Blue Palo Verde  | 10   | M | L          | RFS | SR        |  |  |  |
| 161             | Cercidium microphyllum - Palo Verde   | 6    | M | M          | RFS | LE        |  |  |  |
| 164             | Prosopis velutina - Native Mesquite   | 10   | M | M          | RFS |           |  |  |  |
| 165             | Prosopis velutina - Native Mesquite   | 12+  | M | L          | RFS | SZ,DW     |  |  |  |
| 166             | Cercidium floridum - Blue Palo Verde  | 8    | M | M          | RFS | ,DW       |  |  |  |
| 167             | Prosopis velutina - Native Mesquite   | 8    | M | M          | RFS | ,DW,SL    |  |  |  |
| 168             | Prosopis velutina - Native Mesquite   | 12   | L | L          | NV  | RD,DW     |  |  |  |
| 169             | Cercidium floridum - Blue Palo Verde  | 12+  | L | L          | NV  | RD        |  |  |  |
| 170             | Acacia greggii - Catclaw Acacia       | 10   | M | L          | RFS | LB,TM     |  |  |  |
| 171             | Acacia greggii - Catclaw Acacia       | 8    | M | M          | RFS | VMS       |  |  |  |
| 172             | Acacia constricta - Whitethorn Acacia | 6    | L | L          | NV  | TM,DW     |  |  |  |
| 173             | Cercidium floridum - Blue Palo Verde  | 12+  | L | L          | NV  | DY        |  |  |  |
| 174             | Acacia greggii - Catclaw Acacia       | 12+  | L | L          | NV  | RD,LB,MT  |  |  |  |
| 175             | Cercidium microphyllum - Palo Verde   | 6    | H | H          | TOS | PS        |  |  |  |
| 176             | Cercidium microphyllum - Palo Verde   | 12+  | H | L          | RFS | SZ        |  |  |  |
| 177             | Cercidium microphyllum - Palo Verde   | 6    | H | H          | TOS | PS        |  |  |  |
| 178             | Acacia greggii - Catclaw Acacia       | 8    | M | L          | RFS | LE,LB,TM  |  |  |  |
| 179             | Celtis pallida - Hackberry            | 8    | M | M          | RFS | VMS,TM    |  |  |  |
| 180             | Acacia constricta - Whitethorn Acacia | 8    | L | L          | NV  | DW,BL     |  |  |  |
| 181             | Celtis pallida - Hackberry            | 8    | M | M          | RFS | TM,VMS    |  |  |  |
| 182             | Prosopis velutina - Native Mesquite   | 12   | M | L          | RFS | DW,SZ     |  |  |  |
| 183             | Cercidium floridum - Blue Palo Verde  | 18+  | M | L          | RFS | BL,SZ     |  |  |  |
| 184             | Acacia constricta - Whitethorn Acacia | 6    | L | L          | NV  | TM,DW     |  |  |  |
| 185             | Prosopis velutina - Native Mesquite   | 12+  | L | L          | NV  | LE,DW     |  |  |  |
| 186             | Celtis pallida - Hackberry            | 8    | M | M          | RFS | VMS       |  |  |  |
| 187             | Celtis pallida - Hackberry            | 8    | M | M          | RFS | VMS       |  |  |  |
| 188             | Celtis pallida - Hackberry            | 8    | M | M          | RFS | VMS       |  |  |  |
| 189             | Acacia constricta - Whitethorn Acacia | 6    | H | H          | TOS | PS        |  |  |  |
| 190             | Cercidium floridum - Blue Palo Verde  | 12+  | M | L          | RFS | SZ        |  |  |  |
| 191             | Cercidium floridum - Blue Palo Verde  | 12+  | M | L          | RFS | SZ        |  |  |  |
| 192             | Cercidium floridum - Blue Palo Verde  | 8    | M | M          | TOS | VMS       |  |  |  |
| 193             | Cercidium microphyllum - Palo Verde   | 6    | H | H          | TOS | PS        |  |  |  |
| 194             | Acacia constricta - Whitethorn Acacia | 10   | L | L          | NV  | BL,TM     |  |  |  |
| 195             | Cercidium microphyllum - Palo Verde   | 12   | H | L          | RFS | SZ        |  |  |  |
| 196             | Celtis pallida - Hackberry            | 8    | M | M          | RFS | VMS       |  |  |  |
| 197             | Cercidium microphyllum - Palo Verde   | 12+  | L | L          | NV  | DY        |  |  |  |
| 198             | Cercidium microphyllum - Palo Verde   | 12   | H | M          | RFS | ,SZ       |  |  |  |
| 199             | Celtis pallida - Hackberry            | 6    | M | M          | RFS | TM,VMS    |  |  |  |
| 200             | Celtis pallida - Hackberry            | 6    | M | M          | RFS | TM,VMS    |  |  |  |
| 201             | Celtis pallida - Hackberry            | 8    | M | M          | RFS | TM,VMS    |  |  |  |
| 202             | Cercidium floridum - Blue Palo Verde  | 4    | H | H          | TOS | LB,PS     |  |  |  |
| 203             | Cercidium floridum - Blue Palo Verde  | 4    | H | H          | TOS | LB,PS     |  |  |  |
| 204             | Cercidium floridum - Blue Palo Verde  | 6    | H | H          | TOS | LB,PS     |  |  |  |
| 205             | Cercidium floridum - Blue Palo Verde  | 4    | H | H          | TOS | LB,PS     |  |  |  |
| 206             | Cercidium floridum - Blue Palo Verde  | 10   | H | L          | RFS | LB,SZ     |  |  |  |
| 207             | Cercidium floridum - Blue Palo Verde  | 4    | H | L          | RFS | LB,SZ     |  |  |  |
| 208             | Cercidium floridum - Blue Palo Verde  | 4    | H | H          | TOS | PS        |  |  |  |
| 209             | Cercidium floridum - Blue Palo Verde  | 10   | H | L          | RFS | TM,SZ     |  |  |  |
| 210             | Cercidium floridum - Blue Palo Verde  | 4    | H | H          | TOS | PS        |  |  |  |
| 211             | Cercidium floridum - Blue Palo Verde  | 6    | H | H          | TOS | PS        |  |  |  |
| 212             | Cercidium floridum - Blue Palo Verde  | 18+  | L | L          | NV  | DW,BL     |  |  |  |
| 213             | Cercidium floridum - Blue Palo Verde  | 4    | H | H          | TOS | PS        |  |  |  |
| 214             | Acacia constricta - Whitethorn Acacia | 12   | L | L          | NV  | DW,MT,BL  |  |  |  |
| 215             | Prosopis velutina - Native Mesquite   | 12+  | M | L          | RFS | DW,LB,SZ  |  |  |  |
| 216             | Acacia greggii - Catclaw Acacia       | 10   | M | L          | RFS | LE,TM,SZ  |  |  |  |
| 217             | Cercidium floridum - Blue Palo Verde  | 4    | H | M          | TOS | LE,VMS    |  |  |  |
| 218             | Celtis pallida - Hackberry            | 12   | H | L          | RFS | SZ        |  |  |  |
| 219             | Cercidium floridum - Blue Palo Verde  | 4    | H | H          | TOS | PS        |  |  |  |
| 220             | Cercidium floridum - Blue Palo Verde  | 6    | H | H          | TOS | PS        |  |  |  |
| 221             | Celtis pallida - Hackberry            | 10   | H | L          | RFS | ,SZ       |  |  |  |
| 222             | Celtis pallida - Hackberry            | 10   | H | L          | RFS | SZ        |  |  |  |
| 223             | Cercidium floridum - Blue Palo Verde  | 4    | H | H          | TOS | PS        |  |  |  |
| 224             | Cercidium floridum - Blue Palo Verde  | 8    | H | M          | RFS | VMS,SZ    |  |  |  |
| 225             | Acacia greggii - Catclaw Acacia       | 12+  | H | L          | RFS | LB,SZ     |  |  |  |
| 226             | Acacia greggii - Catclaw Acacia       | 10   | L | L          | NV  | DW,SZ     |  |  |  |
| 227             | Celtis pallida - Hackberry            | 10   | M | L          | RFS | ,SZ       |  |  |  |
| 228             | Celtis pallida - Hackberry            | 8    | M | L          | RFS | ,LB       |  |  |  |
| 229             | Cercidium floridum - Blue Palo Verde  | 12+  | L | L          | NV  | DY        |  |  |  |
| 230             | Cercidium floridum - Blue Palo Verde  | 12+  | L | L          | NV  | DY        |  |  |  |
| 231             | Celtis pallida - Hackberry            | 12   | M | L          | RFS | SZ        |  |  |  |
| 232             | Celtis pallida - Hackberry            | 8    | M | M          | RFS | VMS       |  |  |  |
| 233             | Acacia constricta - Whitethorn Acacia | 10   | M | L          | RFS | TM        |  |  |  |
| 234             | Celtis pallida - Hackberry            | 6    | M | M          | RFS | VMS       |  |  |  |
| 235             | Celtis pallida - Hackberry            | 10   | M | L          | RFS | TM,SZ     |  |  |  |
| 236             | Celtis pallida - Hackberry            | 8    | M | L          | RFS | TM,SZ     |  |  |  |
| 237             | Cercidium floridum - Blue Palo Verde  | 18+  | L | L          | NV  | DW,SZ,RT  |  |  |  |
| 238             | Acacia constricta - Whitethorn Acacia | 8    | L | L          | NV  | DW,LE,DW  |  |  |  |
| 239             | Acacia constricta - Whitethorn Acacia | 10   | M | L          | RFS | DW,LB,SZ  |  |  |  |
| 240             | Cercidium floridum - Blue Palo Verde  | 12+  | M | L          | RFS | DW,SZ     |  |  |  |
| 241             | Cercidium floridum - Blue Palo Verde  | 12+  | M | L          | RFS | DW,SZ     |  |  |  |

|     |                                       |     |   |   |     |          |
|-----|---------------------------------------|-----|---|---|-----|----------|
| 242 | Cercidium floridum - Blue Palo Verde  | 18+ | M | L | RFS | DW,SZ    |
| 243 | Cercidium floridum - Blue Palo Verde  | 12+ | M | L | RFS | DW,SZ    |
| 244 | Cercidium floridum - Blue Palo Verde  | 12  | M | L | RFS | SZ       |
| 245 | Celtis pallida - Hackberry            | 10  | M | L | RFS | LB       |
| 246 | Cercidium floridum - Blue Palo Verde  | 12  | M | L | RFS | LB,LB    |
| 247 | Acacia greggii - Catclaw Acacia       | 4   | M | M | RFS | LE,VMS   |
| 248 | Cercidium floridum - Blue Palo Verde  | 12+ | L | L | NV  | BL,DW    |
| 249 | Cercidium floridum - Blue Palo Verde  | 6   | M | M | TOS | VMS      |
| 250 | Acacia greggii - Catclaw Acacia       | 12  | L | L | NV  | LE,DW    |
| 251 | Acacia greggii - Catclaw Acacia       | 12  | L | L | NV  | LE,DW    |
| 252 | Cercidium microphyllum - Palo Verde   | 18+ | M | L | RFS | SL,SZ    |
| 253 | Cercidium microphyllum - Palo Verde   | 18+ | L | L | NV  | RT,BL    |
| 254 | Celtis pallida - Hackberry            | 8   | M | M | RFS | VMS,LB   |
| 255 | Celtis pallida - Hackberry            | 8   | M | M | RFS | VMS,LB   |
| 256 | Celtis pallida - Hackberry            | 8   | M | M | RFS | VMS,LB   |
| 257 | Cercidium microphyllum - Palo Verde   | 8   | M | L | RFS | SL       |
| 258 | Cercidium microphyllum - Palo Verde   | 12+ | M | L | RFS | SL       |
| 276 | Cercidium microphyllum - Palo Verde   | 8   | M | L | RFS | DW,SL    |
| 277 | Cercidium microphyllum - Palo Verde   | 8   | M | L | RFS | DW,SL    |
| 278 | Cercidium microphyllum - Palo Verde   | 12  | M | L | RFS | DW,SL    |
| 279 | Cercidium microphyllum - Palo Verde   | 18+ | L | L | NV  | DW,SL    |
| 293 | Prosopis velutina - Native Mesquite   | 6   | M | M | RFS | VMS,TD   |
| 294 | Acacia constricta - Whitethorn Acacia | 6   | M | M | RFS | LB       |
| 295 | Cercidium floridum - Blue Palo Verde  | 12+ | L | L | NV  | BL,RT    |
| 296 | Cercidium floridum - Blue Palo Verde  | 18+ | L | L | NV  | BL,RT    |
| 297 | Celtis pallida - Hackberry            | 10  | L | L | NV  | DW,BL    |
| 298 | Prosopis velutina - Native Mesquite   | 12+ | L | L | NV  | DW,LB    |
| 299 | Cercidium floridum - Blue Palo Verde  | 10  | H | H | TOS | PS       |
| 300 | Acacia constricta - Whitethorn Acacia | 4   | H | M | RFS | VMS,LB   |
| 302 | Celtis pallida - Hackberry            | 6   | L | L | NV  | RD,DW    |
| 303 | Prosopis velutina - Native Mesquite   | 18+ | L | L | NV  | BL,DW,SZ |
| 304 | Acacia constricta - Whitethorn Acacia | 4   | H | H | TOS | PS       |
| 305 | Cercidium floridum - Blue Palo Verde  | 10  | L | L | NV  | BL,DW    |
| 306 | Cercidium floridum - Blue Palo Verde  | 8   | L | L | NV  | BL,DW    |
| 307 | Celtis pallida - Hackberry            | 8   | M | M | RFS | VMS,TM   |
| 308 | Acacia constricta - Whitethorn Acacia | 8   | L | L | NV  | DW,LB    |
| 309 | Prosopis velutina - Native Mesquite   | 8   | H | H | TOS | PS       |
| 310 | Cercidium floridum - Blue Palo Verde  | 8   | H | M | RFS | SZ       |
| 311 | Prosopis velutina - Native Mesquite   | 12+ | L | L | NV  | LB,DW    |
| 312 | Cercidium floridum - Blue Palo Verde  | 6   | H | H | TOS | PS       |
| 313 | Acacia greggii - Catclaw Acacia       | 6   | M | L | RFS | ST,LB    |
| 314 | Cercidium floridum - Blue Palo Verde  | 4   | H | H | TOS | PS       |
| 315 | Cercidium floridum - Blue Palo Verde  | 6   | H | H | TOS | PS       |
| 316 | Cercidium floridum - Blue Palo Verde  | 10  | M | L | RFS | DW       |
| 317 | Cercidium microphyllum - Palo Verde   | 6   | M | M | TOS | VMS      |
| 318 | Acacia greggii - Catclaw Acacia       | 6   | M | L | RFS | LB,ST    |
| 319 | Cercidium microphyllum - Palo Verde   | 12+ | H | L | RFS | SZ       |
| 320 | Cercidium microphyllum - Palo Verde   | 10  | H | M | RFS | SZ       |
| 321 | Cercidium microphyllum - Palo Verde   | 12+ | M | L | RFS | SZ       |
| 322 | Acacia constricta - Whitethorn Acacia | 6   | M | M | RFS | VMS,LB   |
| 323 | Acacia greggii - Catclaw Acacia       | 6   | M | L | RFS | TM,LB,ST |
| 324 | Cercidium microphyllum - Palo Verde   | 4   | H | H | TOS | PS       |
| 325 | Cercidium floridum - Blue Palo Verde  | 10  | L | L | NV  | DY       |
| 326 | Acacia constricta - Whitethorn Acacia | 8   | L | L | NV  | DW,MT    |
| 327 | Cercidium microphyllum - Palo Verde   | 6   | L | L | NV  | DW       |
| 328 | Cercidium microphyllum - Palo Verde   | 12  | M | L | RFS | SZ       |
| 329 | Acacia greggii - Catclaw Acacia       | 6   | M | L | RFS | ST,LB    |
| 330 | Cercidium floridum - Blue Palo Verde  | 4   | H | H | TOS | PS       |
| 331 | Prosopis velutina - Native Mesquite   | 8   | M | M | RFS | DW,TM    |
| 332 | Cercidium floridum - Blue Palo Verde  | 10  | M | L | RFS | DW,SZ    |
| 333 | Celtis pallida - Hackberry            | 8   | M | M | RFS | VMS,TM   |
| 334 | Celtis pallida - Hackberry            | 6   | M | M | RFS | VMS,TM   |
| 335 | Acacia constricta - Whitethorn Acacia | 8   | L | L | NV  | RT,DW    |
| 336 | Acacia constricta - Whitethorn Acacia | 8   | L | L | NV  | RT,DW    |
| 337 | Acacia constricta - Whitethorn Acacia | 8   | L | L | NV  | RT,DW,TM |
| 338 | Acacia constricta - Whitethorn Acacia | 12  | L | L | NV  | RT,DW,TM |
| 339 | Acacia constricta - Whitethorn Acacia | 8   | L | L | NV  | RT,DW,TM |
| 340 | Cercidium microphyllum - Palo Verde   | 10  | M | M | RFS | ,SO      |
| 341 | Acacia constricta - Whitethorn Acacia | 6   | L | L | NV  | LB,DW    |
| 342 | Prosopis velutina - Native Mesquite   | 8   | M | M | RFS | ,DW      |
| 343 | Condalia globosa - Bitter Condalia    | 10  | M | L | RFS | LB,ST,DW |
| 344 | Cercidium microphyllum - Palo Verde   | 10  | L | L | NV  | BL       |
| 345 | Cercidium floridum - Blue Palo Verde  | 6   | H | H | TOS | PS       |
| 346 | Cercidium floridum - Blue Palo Verde  | 6   | H | M | TOS | VMS,LB   |
| 347 | Cercidium floridum - Blue Palo Verde  | 12  | L | L | NV  | DW       |
| 348 | Cercidium microphyllum - Palo Verde   | 4   | M | M | TOS | MS       |
| 349 | Cercidium floridum - Blue Palo Verde  | 12  | L | L | NV  | BL,MT    |
| 350 | Acacia greggii - Catclaw Acacia       | 8   | M | L | RFS | TM,LB    |
| 351 | Cercidium floridum - Blue Palo Verde  | 8   | M | M | RFS |          |
| 352 | Acacia constricta - Whitethorn Acacia | 8   | L | L | NV  | DW,RT    |
| 353 | Acacia greggii - Catclaw Acacia       | 8   | M | M | RFS | ,TM      |
| 354 | Prosopis velutina - Native Mesquite   | 18+ | L | L | NV  | DW,TM,SZ |
| 355 | Prosopis velutina - Native Mesquite   | 12  | L | L | NV  | DW,TM,SZ |
| 356 | Cercidium floridum - Blue Palo Verde  | 12+ | M | L | RFS | LB,SZ    |
| 357 | Cercidium floridum - Blue Palo Verde  | 6   | H | H | TOS | PS       |
| 358 | Acacia constricta - Whitethorn Acacia | 6   | H | L | RFS | LB       |
| 359 | Cercidium floridum - Blue Palo Verde  | 10  | M | M | RFS | ,SZ      |
| 360 | Cercidium floridum - Blue Palo Verde  | 10  | L | L | NV  | BL,DW    |
| 361 | Cercidium floridum - Blue Palo Verde  | 8   | M | M | RFS | VMS,LB   |
| 362 | Cercidium floridum - Blue Palo Verde  | 12  | L | L | NV  | DY       |
| 363 | Cercidium floridum - Blue Palo Verde  | 4   | H | M | RFS | VMS,SO   |
| 364 | Acacia greggii - Catclaw Acacia       | 6   | M | L | RFS | ST,DW,LB |
| 365 | Acacia greggii - Catclaw Acacia       | 6   | M | L | RFS | ST,DW,LB |
| 366 | Acacia constricta - Whitethorn Acacia | 6   | L | L | NV  | LB,DW    |
| 367 | Cercidium floridum - Blue Palo Verde  | 18+ | M | L | RFS | SZ       |
| 368 | Prosopis velutina - Native Mesquite   | 18+ | L | L | NV  | SZ,MT    |
| 369 | Cercidium floridum - Blue Palo Verde  | 6   | M | M | TOS | MS       |
| 370 | Acacia constricta - Whitethorn Acacia | 6   | M | L | RFS | LB,DW    |
| 371 | Cercidium microphyllum - Palo Verde   | 6   | M | M | TOS | MS,LB    |
| 372 | Celtis pallida - Hackberry            | 6   | M | M | RFS | VMS,TM   |
| 373 | Celtis pallida - Hackberry            | 6   | L | L | NV  | DW       |
| 374 | Cercidium microphyllum - Palo Verde   | 6   | H | H | TOS | PS       |
| 375 | Cercidium microphyllum - Palo Verde   | 6   | H | M | TOS | MS,LB    |