

# Melcor Development Ltd.-Rivers Edge

## Project Information Sheet

### Project Summary:

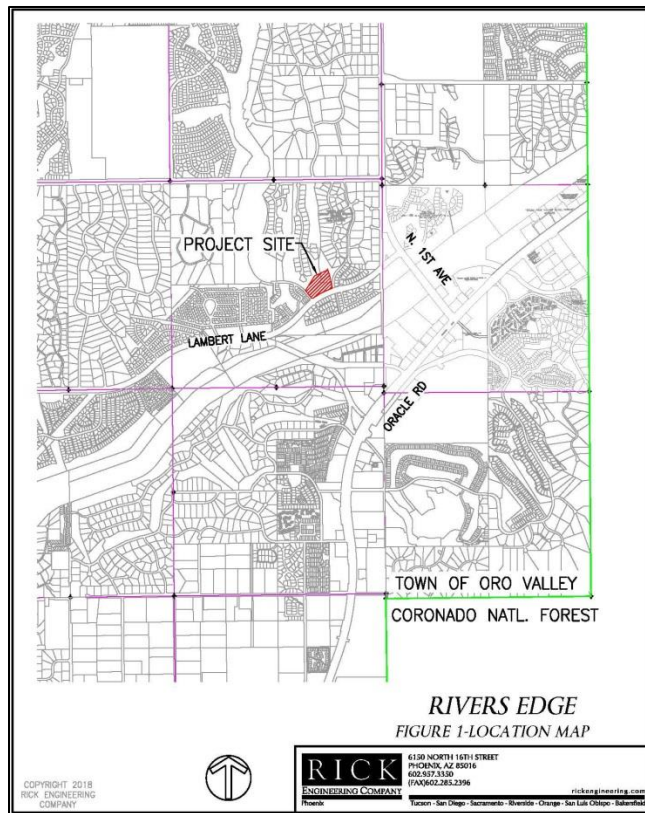

**Site Acreage:** 6.46 acres

**Existing Land Use:** Vacant

**Exiting Zoning:**

Melcor Planned Area Development (PAD),  
Transitional (TR), Cluster (CR-2) and Multifamily  
(CR-5)

**Town of Oro Valley General Land Use**

**Designation:** Medium Density Residential (2.1-  
5 DU/Ac).

**Project is subject to:** The Villa Del Oro Design  
Guidelines dated 12/9/1986, and PAD Hillside  
Ordinance

**Town of Oro Valley, ESL Map Designation:**

Resource Management Area Tier 2 (25% Open  
Space).

**Proposed Land Use:** Single Family Residents

For additional information, please contact:

Rick Engineering Company  
Dawn Fortuna, AICP  
6150 North 16<sup>th</sup> Street  
Phoenix, AZ 85016

