



Sun City Oro Valley Plaza Lion Head Fountain

For three decades, the Sun City Oro Valley (SCOV) Plaza Lion Head Fountain has been a featured element of the SCOV community. The fountain was shut down due to construction of the adjacent SCOV Activity Center. It could not be brought back into service because it had not been used within the 6-month time period, as required by 2010 town code.

The SCOV Board of Directors created a task force to reach out the SCOV community residents and found there was substantial support to re-establish and restore the original fountain. As good stewards, the task force recognized that water is a precious commodity in the desert, and developed a plan to reduce the size of the existing fountain design by over 50%. In addition, the task force has proposed using highly efficient equipment, resurfacing the basin to eliminate water leakage, and removing adjacent trees no longer permitted by code. Collectively, this will make a considerable reduction of the fountain's annual water usage, estimated to be less than that used by the average Oro Valley single family household. SCOV also hopes to one day additionally supplement the fountain with rainwater harvesting to further reduce potable water usage.

With proposed improvements, the SCOV community is seeking permission from the Town, in the form of a zoning text amendment to Rancho Vistoso PAD District #5, Neighborhood #1, to allow the use of water once again in a consciously improved SCOV Plaza Lion Head Fountain.

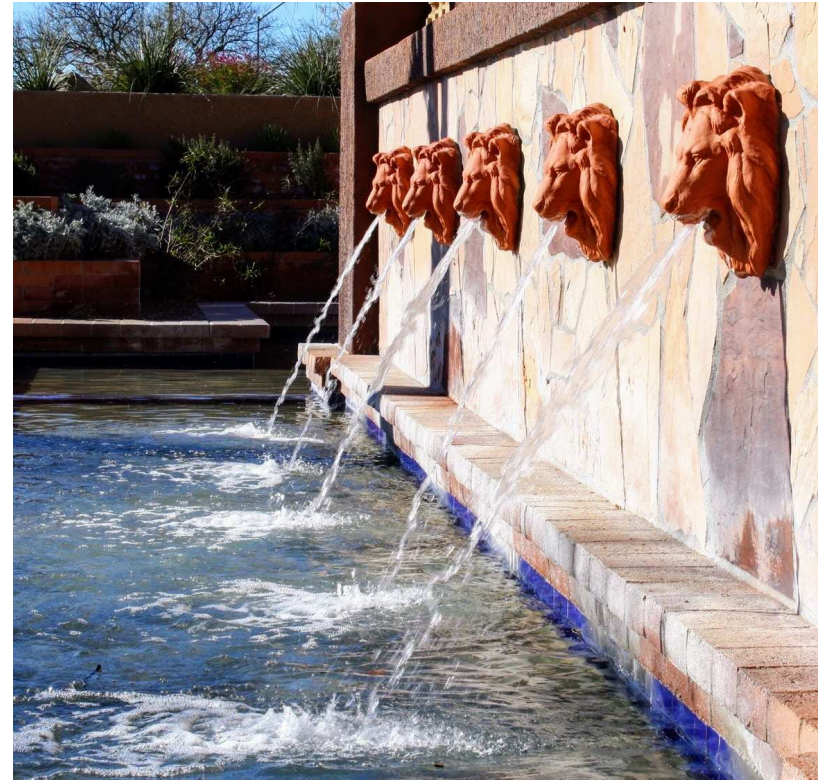
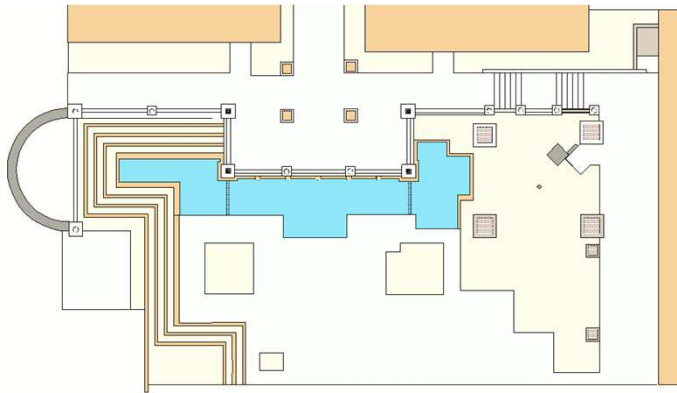
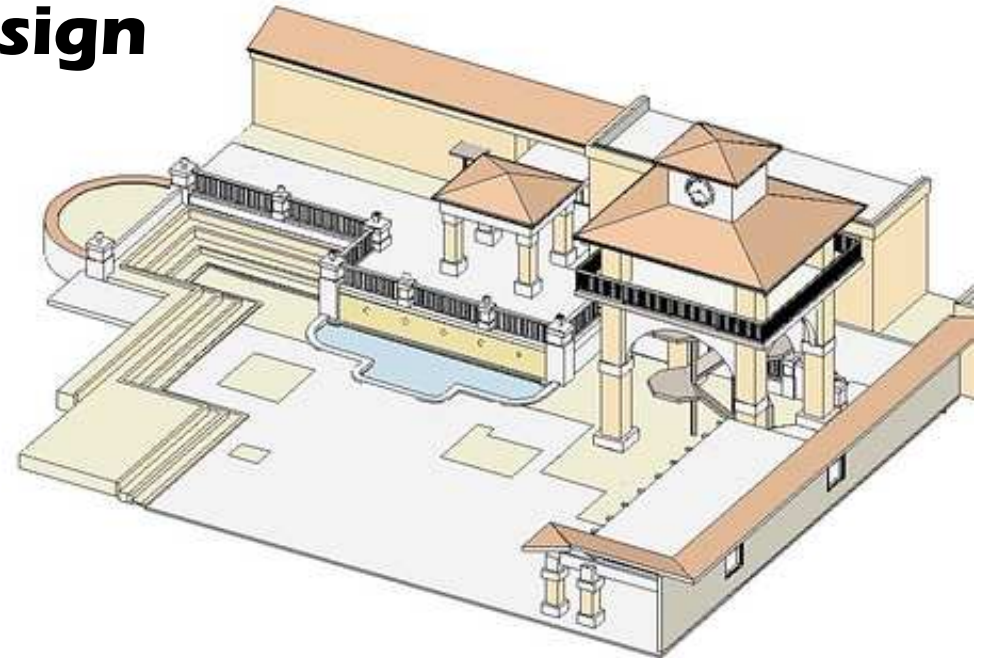
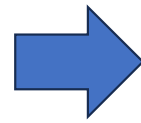

Photo courtesy of C.DeWidt

Lion Head Fountain Redesign



Original Design (top-down view)



Features:

- Significantly less water usage & evaporation *over 50% reduction*
- Significant efficiency improvements *variable speed programmable pump (1), skimmer, filter*
- Less overall maintenance *skimmer, rounded corners, surrounding ADA curb*
- ADA compliant 6" h x 12" w lip *complies with Town code*
- Frees up space for future uses *stairs, stage, ramada, seating, outdoor gathering, events*

Planned Structure Repair:

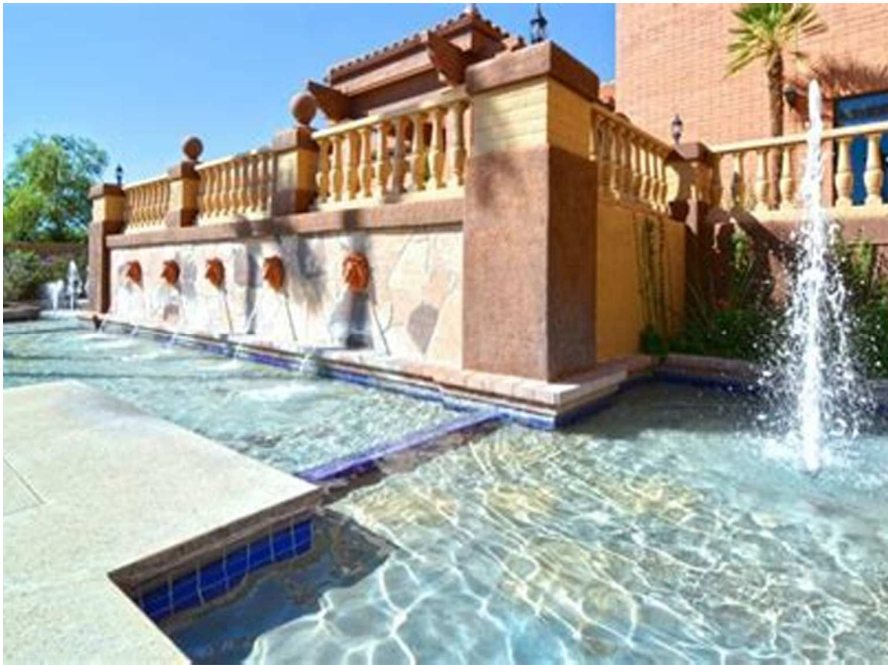

To Do:

- ✓ tree roots
remove adjacent non-conforming palms & trees
- ✓ 50%+ size reduction
remove fountain basin side wings and 6' spray heads
- ✓ cracks
re-surface entire remaining basin to prevent leaks
- ✓ damaged tiles
install all new waterline and wall tile